

sunparadise

# SUNSHADING SYSTEM

Louver





# Louver

Simple and perfect  
solution for  
upgraded  
interior life.



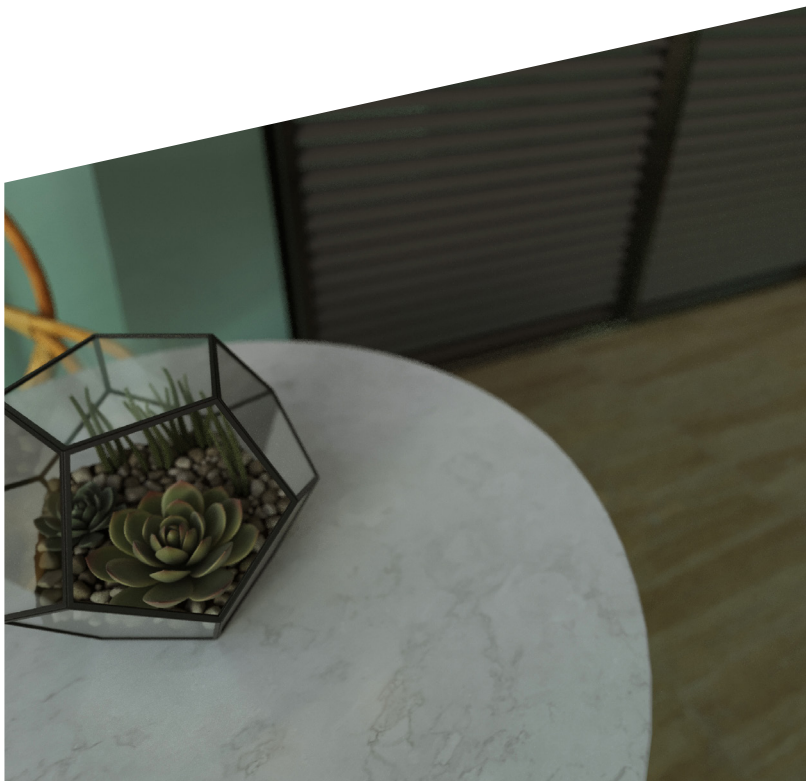

## Think exterior first for interior comfort

Redesign your building with Louver;  
Raise your living standards.

### Smart solution

Louver is perfect and cost effective system to control light entry while screening interior and maintaining rain defence. It is best aesthetic and functional addition to your building exterior.

### Perfect combination

Louver aims to make your life easier for your interior life with its solid structure and easy combined feature with glass systems. You can directly adapt full glazed systems on louver's rails.

### Benefits of Louvre

- Sliding systems allows you to modify position by light direction.
- Whole solution in a single system with built-in full glazed system.
- Maximum rail length with 6m

For your pure 'Staycation' pleasure.





The best ; even for  
your needs that you  
haven't yet  
discovered.

**Your Sunparadise Specialist Partner**

Take advantage of the wide range of Sunparadise products and our proven expert consultations. Further information can be found at

**[sunparadise.com](https://sunparadise.com)**